

How to Connect Roku Express Player to your TV

What's included

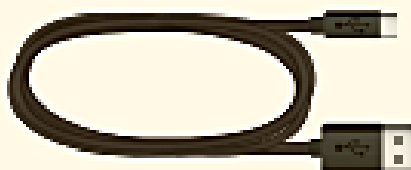

Roku Express Streaming Player



USB Power Cable

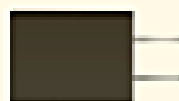

Power Adapter

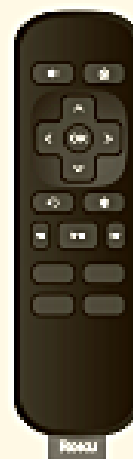

Remote



High Speed HDMI* Cable



Two AAA Batteries

Roku Express Streaming Player details

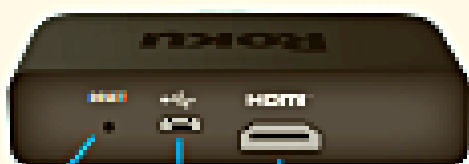

Reset

USB Power

HDMI



Front



Top



Back



Bottom

Setup



STEP 1:
Connect to TV
Use the included High Speed HDMI Cable (or your own HDMI cable) to connect the Roku to your TV.

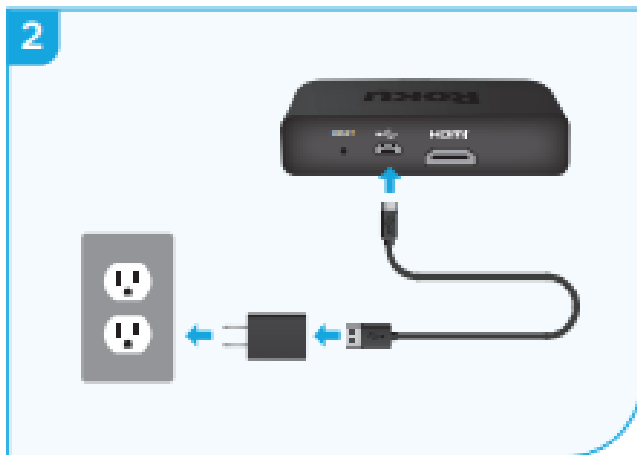

STEP 2:
Connect to power
For the best streaming experience, use the included USB power cable and power adapter to connect the Roku to a wall outlet.

OR

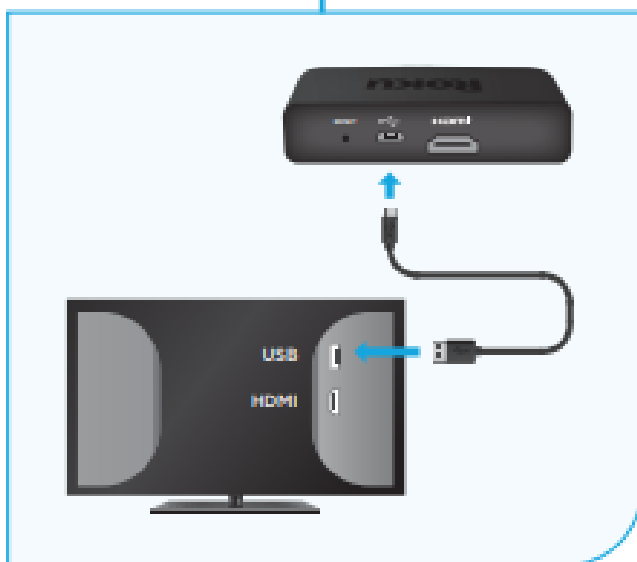

Or use the included USB power cable to connect to the USB port on your TV.

NOTE: Not all TV USB ports provide enough power. If you see a red light on the Roku player, that means the USB port does not have enough power. Use the included power adapter instead.

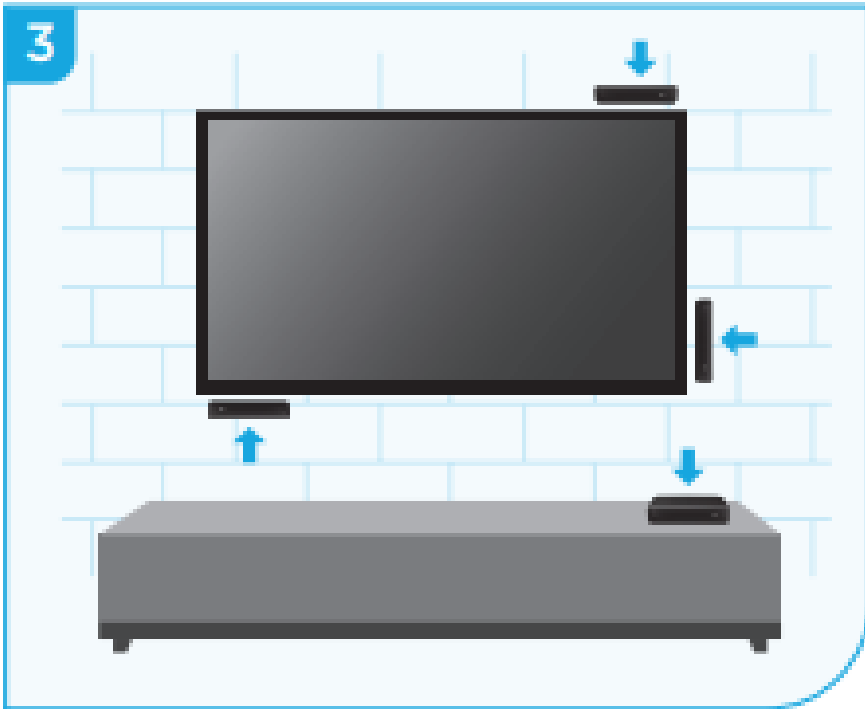

STEP 3:
Position Roku streaming player
Place the streaming player near your TV.

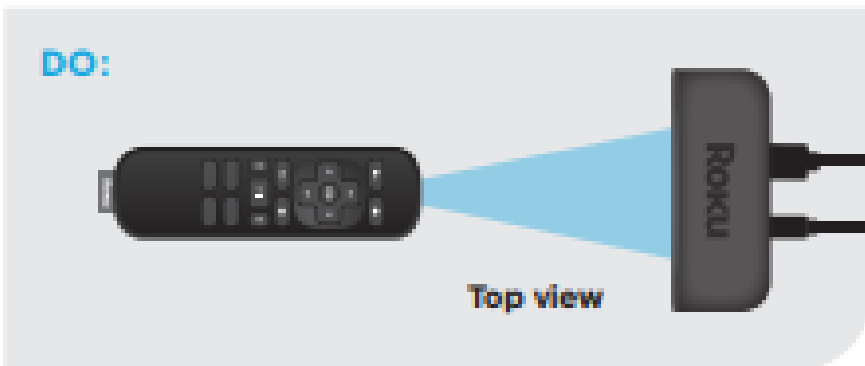

DO make sure that the front of the Roku player has direct line of sight with the remote control.



DO NOT place inside a TV cabinet. Doing so may cause overheating.

4

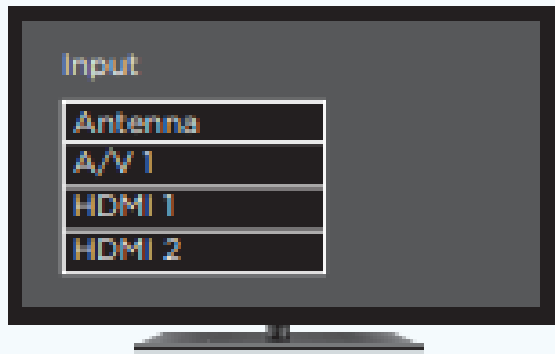

STEP 4:

Power on TV and select input
Use your TV remote to power on your TV and select the input you used to connect your streaming player.

For help on how to select the correct input, visit
go.roku.com/selectinput

For more help with setup and troubleshooting, visit
<https://support.roku.com/category/115001360548--troubleshooting>
for helpful video tutorials.